

AKABA



Tknika Contract

H450 - H750 - H1050

Programa de mesas versátil para contract, oficina y hospitality con máximas posibilidades de dimensiones y alturas diferentes según versión.

Nudos de aluminio inyectado a alta presión, opción nudo de pie directo, opción nudo para unión de 90° y opción nudo de 180°.

Patas en extrusión de aluminio 67,5x50 mm o en madera maciza 67,50x50 mm barnizada natural.

Largueros de acero pintado 40x30mm y travesaños de encimeras de unión 80x40mm.

Encimeras en melamina 20mm, compacto 13mm, fenix 20mm o madera chapeada 20mm.

Acabados metálicos pintura en polvo epoxi/poliéster de espesor 50-90 micras según color, adherencia ISO 2409 Gt 0 e impacto ASTM 2794 2,5 Joule D/R o acabado cromado composición 98,4 % NI 1,6 % CR, 24,4 micras de espesor y adherencia UNE EN ISO 2409-96 Clasificación 0.

ENVIRONMENTAL CERTIFICATES

UNE-EN 15372 Mobiliario. Resistencia, durabilidad y seguridad. Furniture - Strength, durability and safety.

ISO 14006 Ecodesign.

EPD (Declaración medioambiental de producto, Environmental product declaration. Reciclable hasta un 99%.

 Recyclable up to **Reciclable hasta un 100 %**.

MEASURES

TKNIKA CONTRACT H450

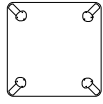

900x900mm
1000x1000mm
1000x1100mm



1200x600mm

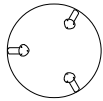

Ø900mm
Ø1000mm
Ø1100mm

TKNIKA CONTRACT H750

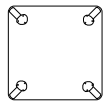

900x900mm
1000x1000mm

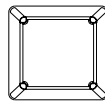

1100x1100mm
1200x1200mm
1400x1400mm
1600x1600mm
1800x1800mm

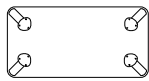

1200x600mm

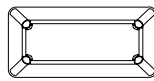

1400x700mm
1600x800mm
1800x900mm
2000x1000mm
2200x1100mm
2400x1200mm
2600x1200mm
2800x1200mm

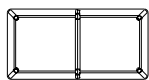

2800x1400mm
2800x1600mm
3200x1200mm
3200x1400mm
3600x1200mm
3600x1400mm
3600x1600mm
3800x1400mm
3800x1600mm
4000x1400mm
4000x1600mm
4200x1400mm
4200x1600mm

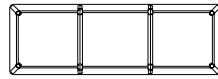

5400x1400mm
5400x1600mm
6000x1400mm
6000x1600mm

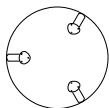

Ø900mm
Ø1000mm

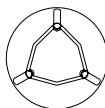

Ø1100mm
Ø1200mm
Ø1400mm
Ø1600mm

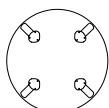

Ø1400mm
Ø1600mm
Ø1800mm

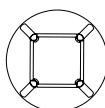

Ø1400mm
Ø1600mm
Ø1800mm

TKNIKA CONTRACT H1050

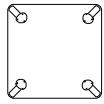

900x900mm
1000x1000mm

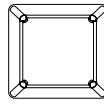

1100x1100mm
1200x1200mm
1400x1400mm
1600x1600mm



1200x600mm

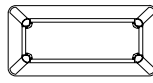

1400x700mm
1600x800mm
1800x900mm
2000x900mm
2200x900mm

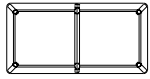

2600x1200mm
2800x1200mm
3200x1200mm
3600x1200mm



5400x1000mm

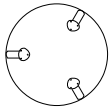

Ø900mm
Ø1000mm

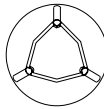

Ø1100mm
Ø1200mm
Ø1400mm

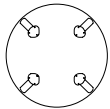

Ø1100mm
Ø1200mm

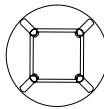

Ø1400mm
Ø1600mm
Ø1800mm

ACCESORIES



Top access / TK
Ø80mm pitch.
Round metal top
access with
removable cover.
Customisable
colour.



Electrification Tray /
TK
420x137x130mm.
Metallic tray for
electrification
housing.
Customisable in
colour.



Grill tray / TK
400x150x60mm.
700x150x60mm

IMAGES



AKABA

Atallu kalea 14
20170 Usurbil (Gipuzkoa)
Spain

akaba@akaba.net
T +34 943 372 211
F +34 943 371 052

© AKABA S.A. All rights reserved